

1 / 10 SCALE RC 4WD HIGH PERFORMANCE DRIFT CAR

MS-01D

RTR/S

1 / 10 DRIFT CHASSIS

MS-01D RTR/S

ON ROAD USE ONLY
FULL BALL BEARINGS

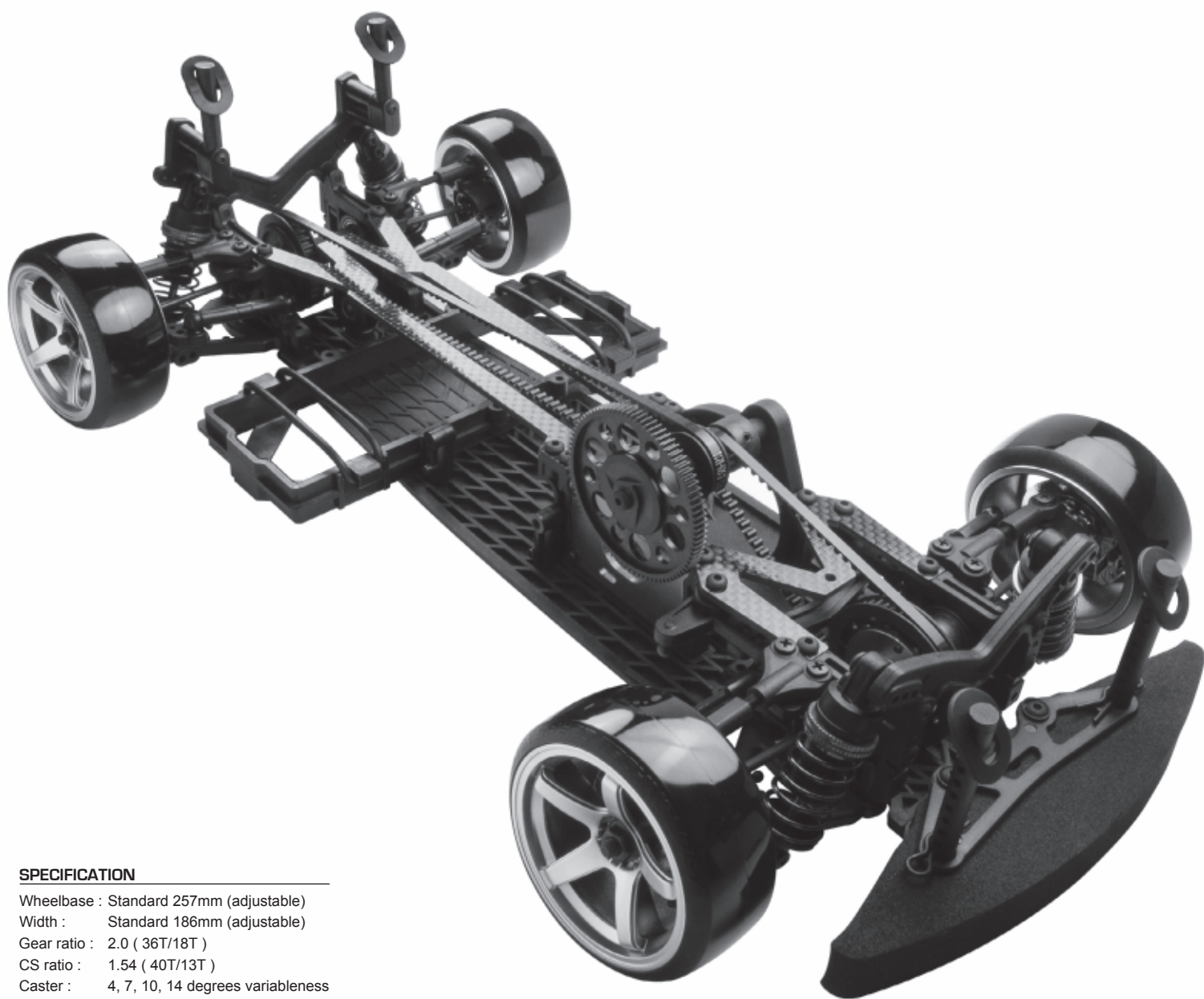

SPECIFICATION

Wheelbase : Standard 257mm (adjustable)
Width : Standard 186mm (adjustable)
Gear ratio : 2.0 (36T/18T)
CS ratio : 1.54 (40T/13T)
Caster : 4, 7, 10, 14 degrees variableness
Camber : 0 to -12 degrees
Front : Alum. one way
Rear : Spool unit

※ Specification are subject to change without notice.



Appreciate for your choice of **MST MS-01D RTR!** You will be impressed with its performance and beauty. Please prepare additional parts as car battery, transmitter battery, and charger. Please follow the process for assemble and setting of parts package. If you have doubt or need assistance, please contact the purchased shop or hobby shop for help, many thanks!

首先感謝你購入 **MST MS-01D RTR** 這項產品，您將擁有一部兼具性能與美型的甩尾車。在首次操作前，有以下幾項須要另行購置的物件：車用電池、遙控器用電池、充電器。備妥上述物件後，請進行零件包安裝與設定。如需其他協助，請向原購買店家，或遙控模型店詢問！謝謝！

PLEASE FOLLOW BELOW OPERATIONS BEFORE ASSEMBLING THE PARTS PACKAGE.

- ❶ Install transmitter batteries.
- ❷ Loosen receiver antenna.
- ❸ Connector ESC and battery.
- ❹ Switch on the transmitter.
- ❺ Trims the transmitter in neutral.
- ❻ Switch on the ESC.
- ❼ Steering wheel in neutral.
- ❽ Attach fittings.
- ❾ After attaching servo saver, Switch off transmitter & ESC.

請於安裝零件包之前，執行以下操作

- ❶ 安裝遙控器電池
- ❷ 鬆開接收機天線
- ❸ 聯結車用電池與電子變速器
- ❹ 打開遙控器電源
- ❺ 調整遙控器各微調器至中立點
- ❻ 打開電子變速器電源
- ❼ 方向轉盤至中立點
- ❽ 安裝零件包
- ❾ 請在安裝伺服緩衝器之後，將遙控器與電子變速器關閉

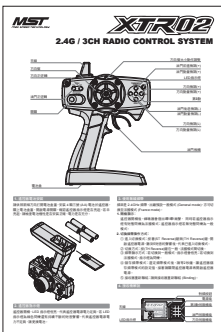

※ Please refer to instruction of transmitter & receiver performance. 遙控器及接收機功能說明請參閱詳細說明書。

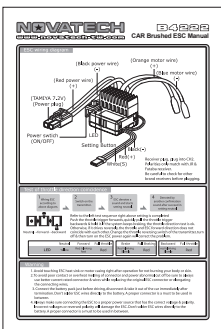

※ Please refer to instruction of ESC performance. 電子變速器功能說明請參閱詳細說明書。

STEP 1 FACTORY ELECTRONIC SETTING

原廠電裝配線圖

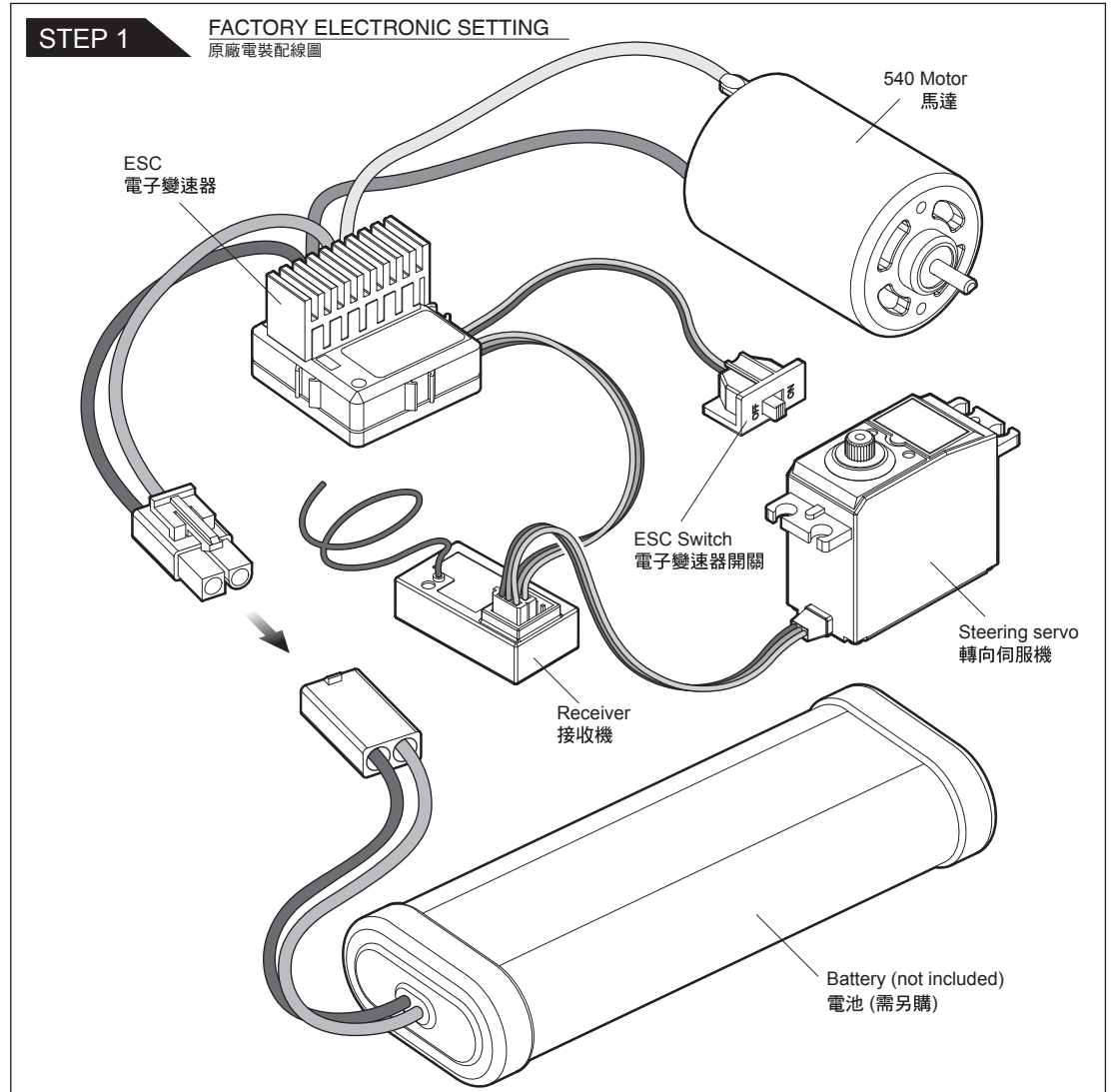

STEP 2 STEERING ROD ASSEMBLY

轉向伺服拉桿組裝

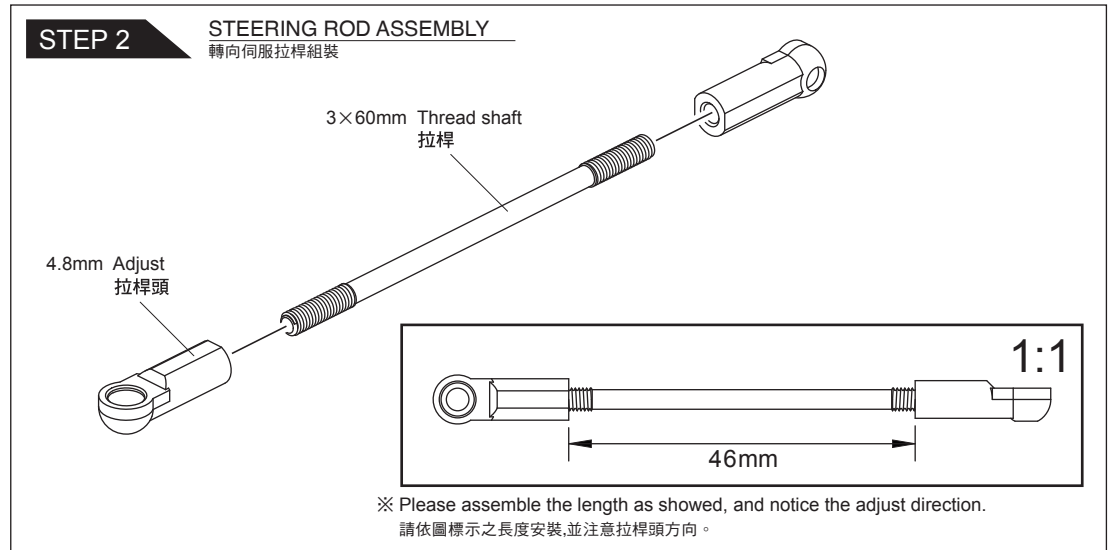

※ Please assemble the length as showed, and notice the adjust direction. 請依圖標示之長度安裝，並注意拉桿頭方向。

STEP 3

SERVO SAVER ASSEMBLY
 伺服緩衝組裝

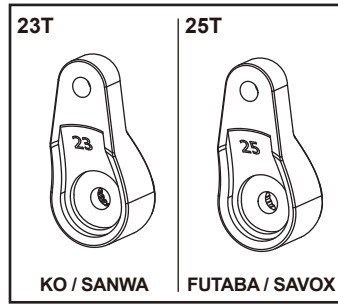
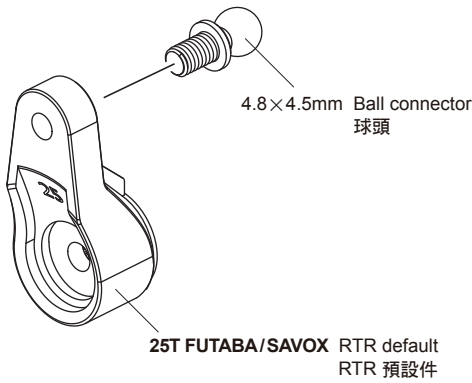

※ Match part with servo.
 挑選合適的零件安裝。

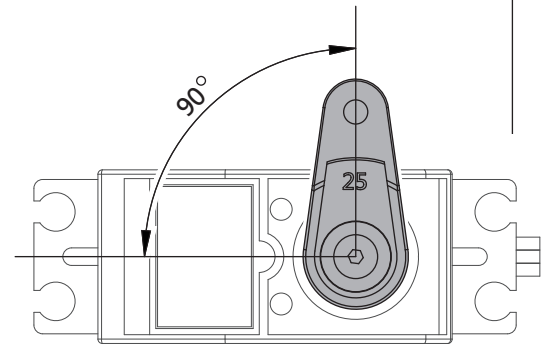

※ Attach as shown with servo in neutral.
 請於調整伺服中立點後,依圖示安裝緩衝組。

STEP 4

ATTACHING STEERING ROD & SERVO HORN
 伺服拉桿 & 伺服舵片安裝

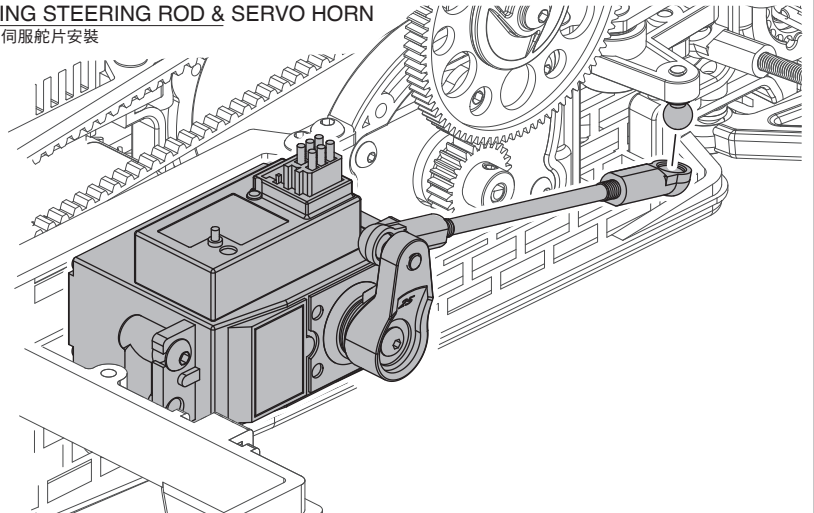
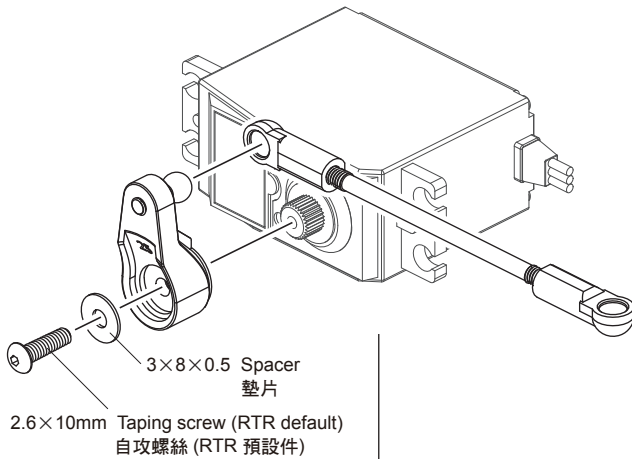

STEP 5

ATTACHING BATTERY
 電池安裝

※ The assembly and conservation method may be different by specification of battery.
 電池的安裝方式會因為廠牌規格而有些微差異,電池的使用方式與保存方式,也會因電池的種類而有所不同。

※ Recommended battery measurement L140xW48xH125.4mm (not exceed)
 建議安裝長40x寬48x高125.4mm尺寸以內的電池。

Battery O-ring (S)
 電池O環 (S)

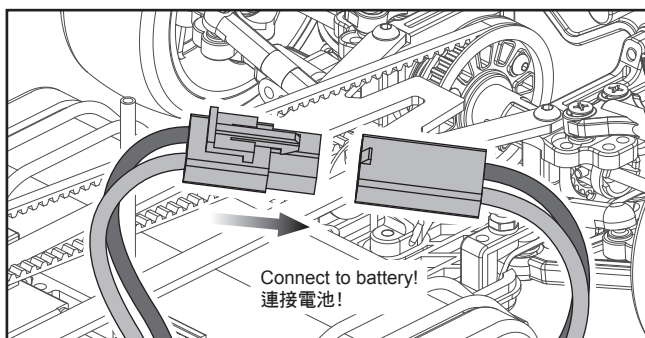
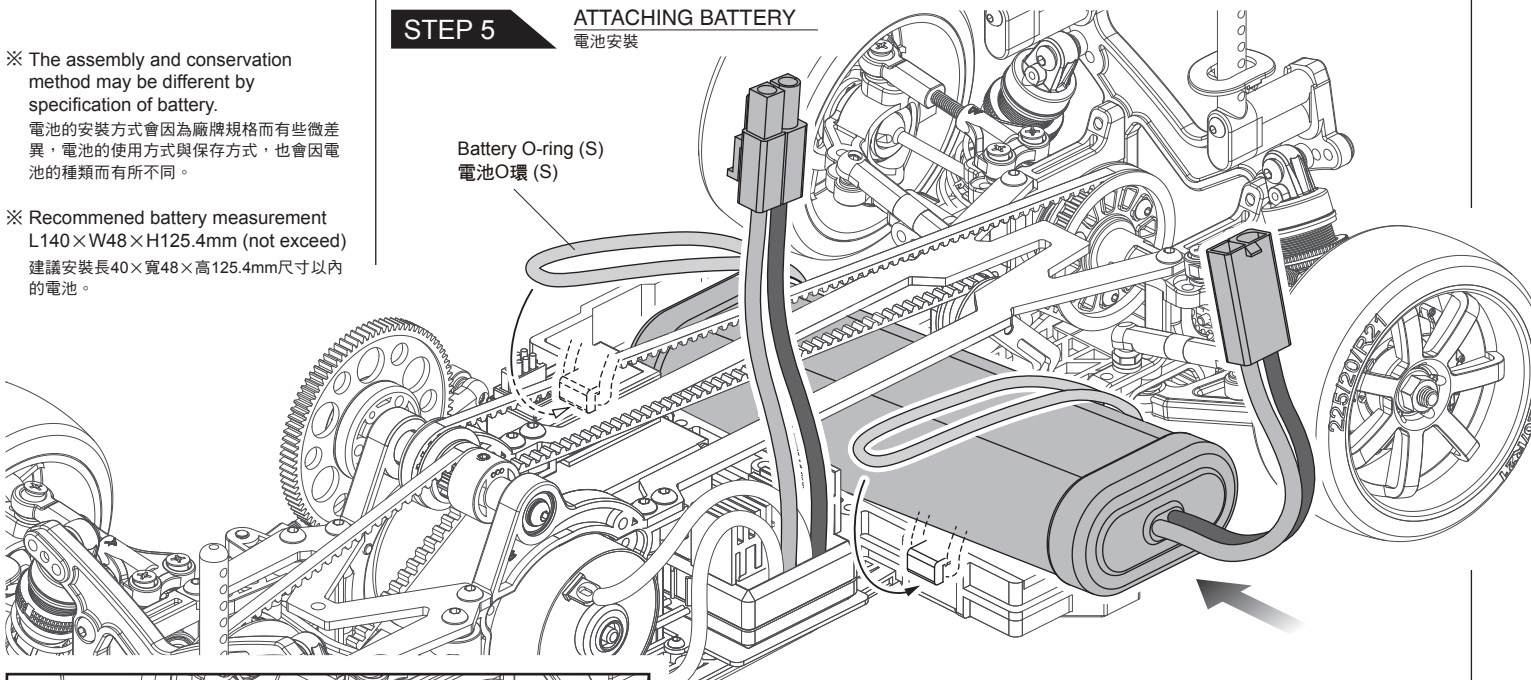

※ Please play in safe place after all setting finish.
 Before playing, please switch on transmitter then on the car.
 Please switch off reversely.
 安裝設定完成後,請於安全場所使用本產品!
 使用前請先開啟遙控器電源後再開啟車體電源!
 使用後請反向操作關閉!

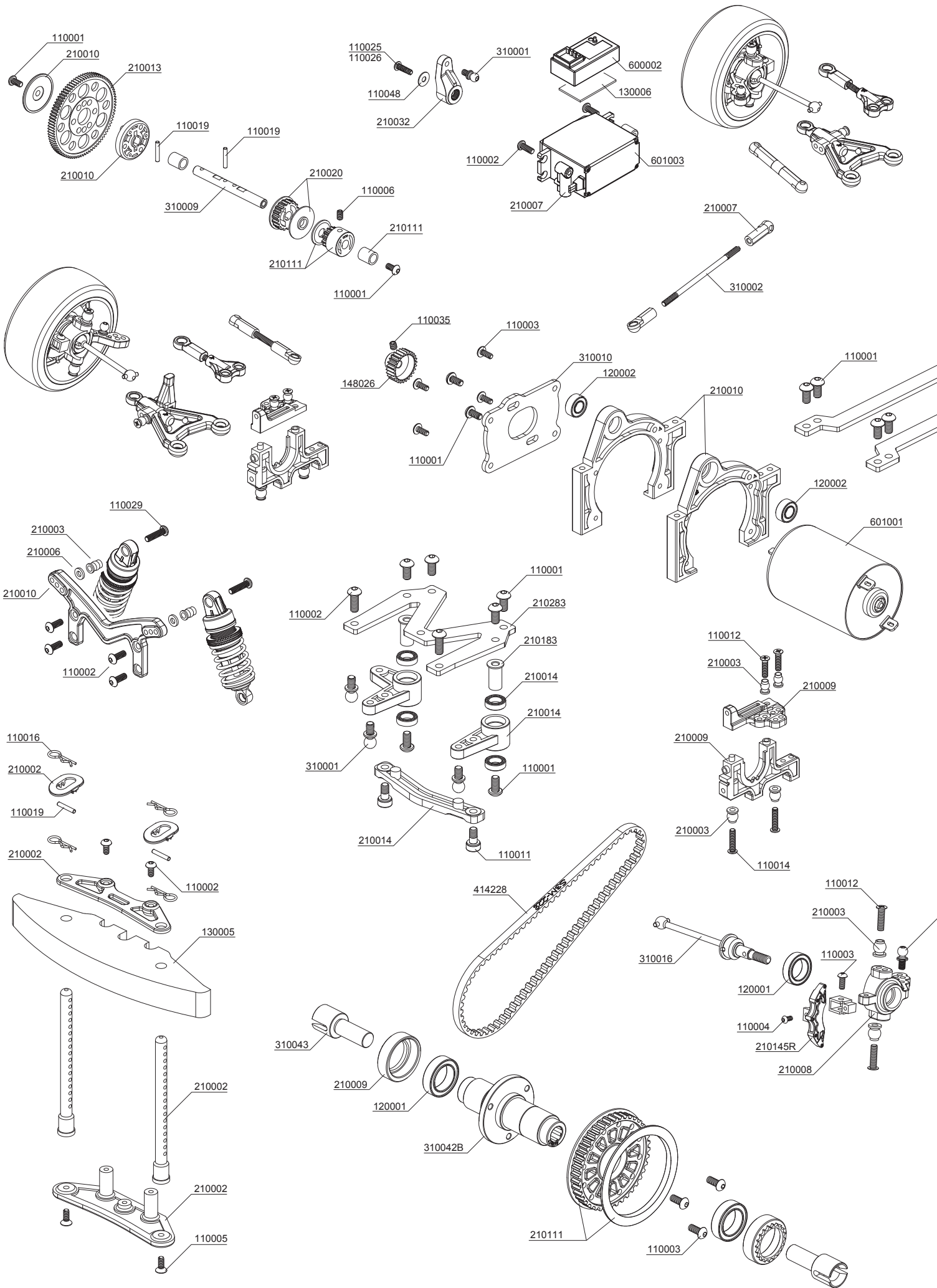

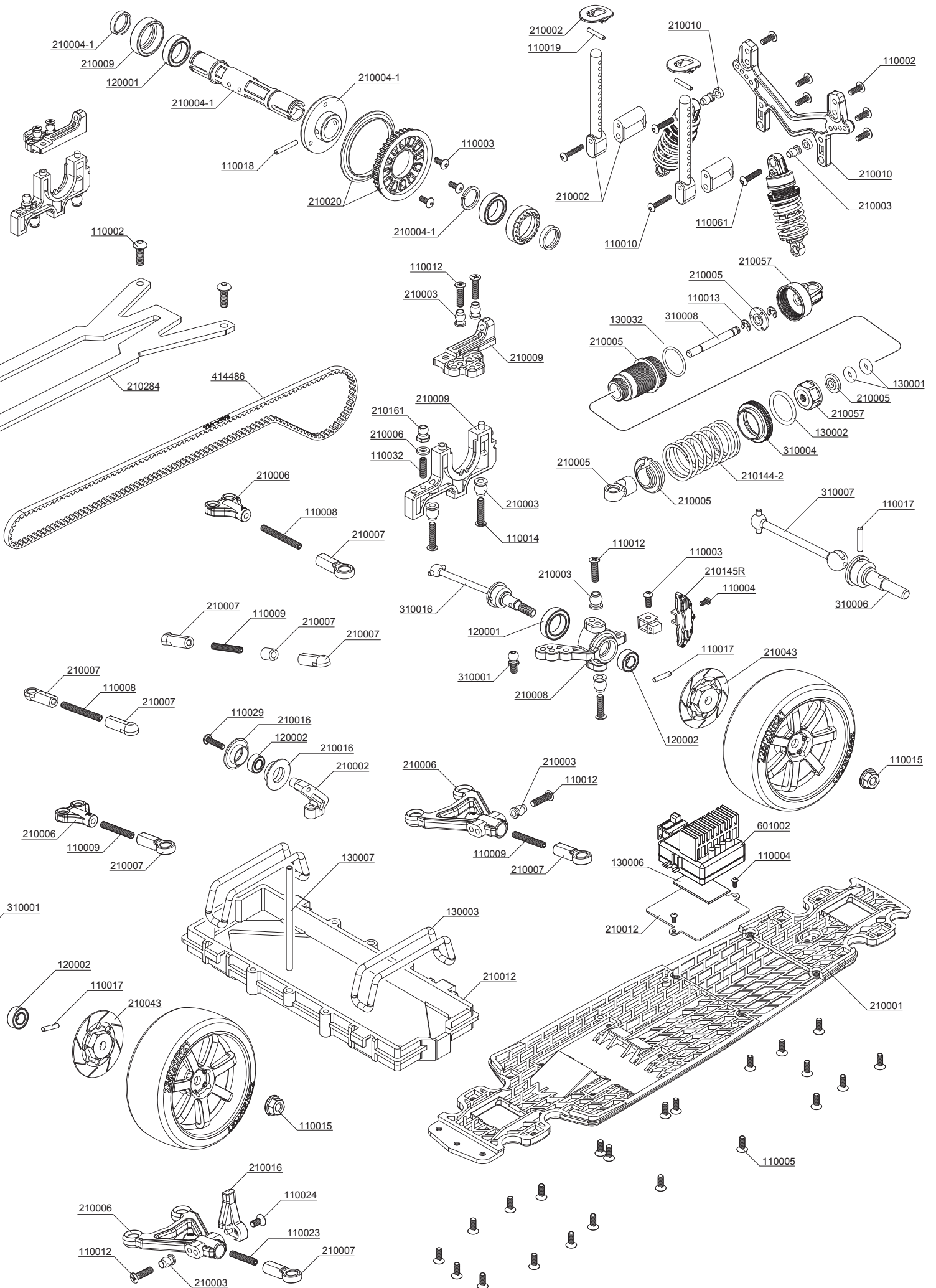

PARTS

不使用
Not Used

M3×14 半圓頭螺絲 ×2
Screw
110061

M2.5×14 半圓頭螺絲 ×2
Screw
110010

M3×12 半圓頭螺絲 ×3
Screw
110029

M2.5×6 半圓頭螺絲 ×14
Screw
110003

M3×10 半圓頭螺絲 ×1
Screw
110026

M2×4 半圓頭螺絲 ×6
Screw
110004

M3×8 半圓頭螺絲 ×18
Screw
110002

2.6×10 自攻半圓頭螺絲 ×1
Screw
110025

M3×6 半圓頭螺絲 ×14
Screw
110001

M3×6 CAP螺絲 ×2
Screw
110011

M3×8 沉頭螺絲 ×24
Screw
110005

M3×11 扁頭螺絲 ×20
Screw
110012

M3×6 沉頭螺絲 ×2
Screw
110024

M3×13 扁頭螺絲 ×8
Screw
110014

M3×25 止付螺絲 ×4
Screw
110008

2×13.8 插銷 ×1
Shaft
110018

M3×20 止付螺絲 ×6
Screw
110009

2×11.8 插銷 ×6
Shaft
110019

M3×16 止付螺絲 ×2
Screw
110023

2×9.8 插銷 ×8
Shaft
110017

M3×10 止付螺絲 ×2
Screw
110032

M4 突緣螺帽 ×4
Nut
110015

M3×5 止付螺絲 ×1
Screw
110006

R6 R形扣 ×6
R-clip
110016

M3×3 止付螺絲 ×1
Screw
110035

3×8×0.5mm 墊片 ×1
Spacer
110048

E2.0 E形扣 ×8
E-clip
110013

10×15 滾珠軸承 ×8
Ball bearing
120001

5×10 滾珠軸承 ×7
Ball bearing
120002

阻尼器O環 P3 (紅) ×8
Damper O-ring P3 (red)
130001

11.5×1.5 O形環 ×4
O-ring
130002

電池O環 (S) ×2
Battery O-ring (S)
130003

避震上蓋O環 ×4
Damper cap O-ring
130032

泡棉雙面膠 ×1
Double sided tape
130006

天線管 ×1
Antenna pipe
130007

防撞泡棉 (A) ×1
Bumper (A)
130005

工具包 ×1
Tools
130011

210002
C 部品
C parts

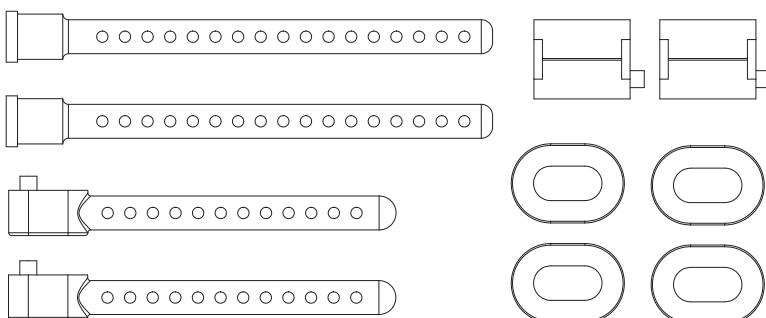
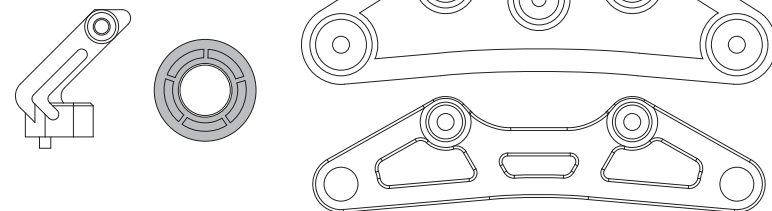

210003 ×4
D 部品
D parts

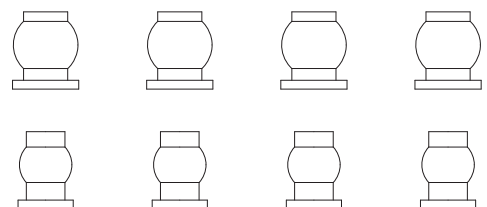

PARTS

210004
E 部品
E parts

210020
皮帶齒 18T/36T
18T/36T pulley

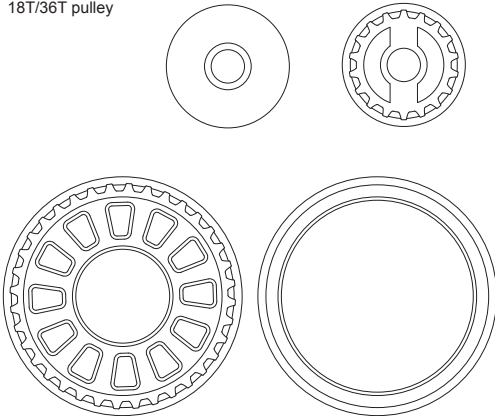

210004-1
直軸組
Spool unit

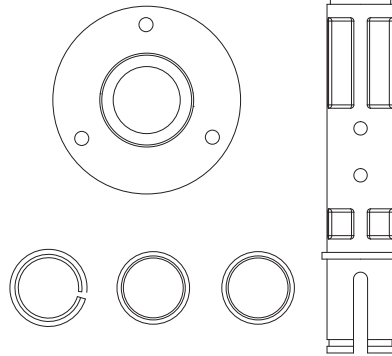

210057 ×2
避震器上下蓋組
Damper cap set

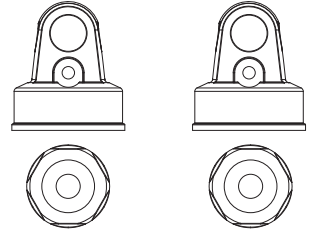

210005 ×2
F 部品
F parts

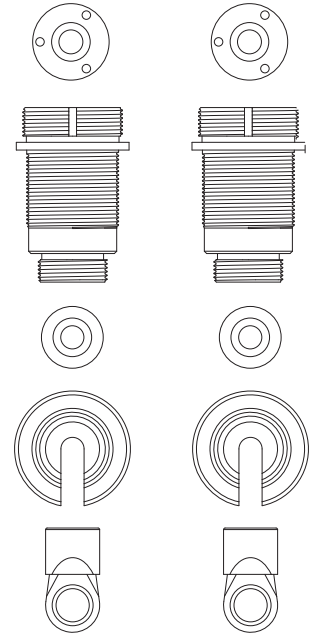

210007 ×2
H 部品
H parts

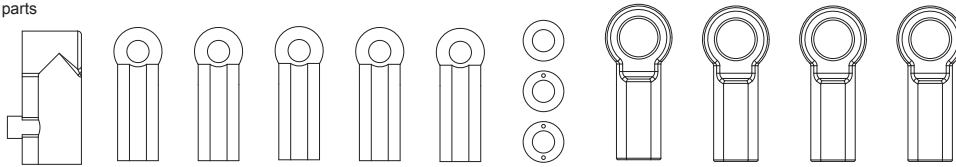

210043
碟型六角輪座組
Wheel hubs w/disc shape

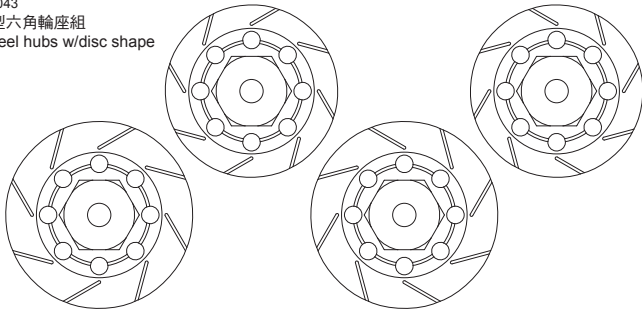

210008 ×2
I 部品
I parts

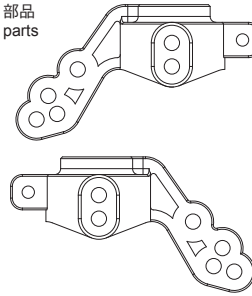

210009 ×2
J 部品
J parts

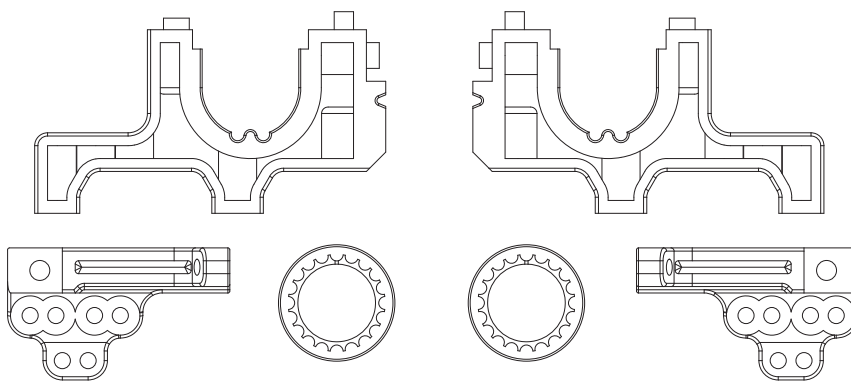

210006 ×4
G 部品
G parts

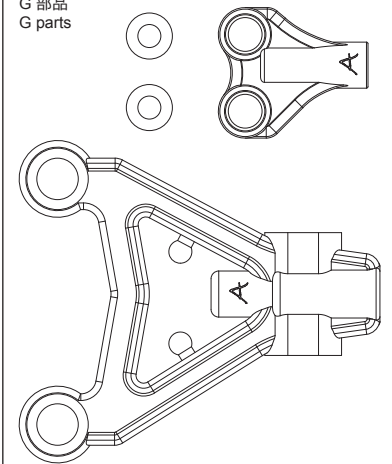

210001
底盤
Lower deck

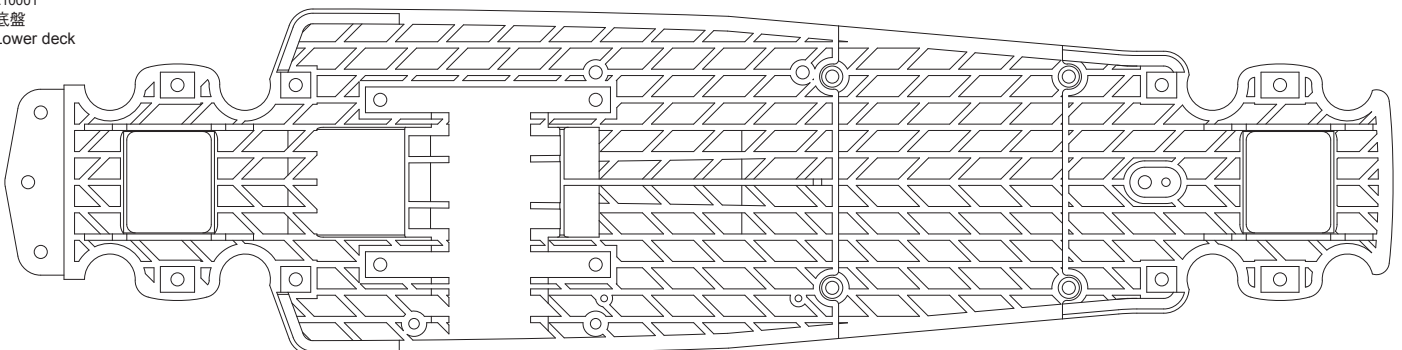

PARTS

210010
K 部品
K parts

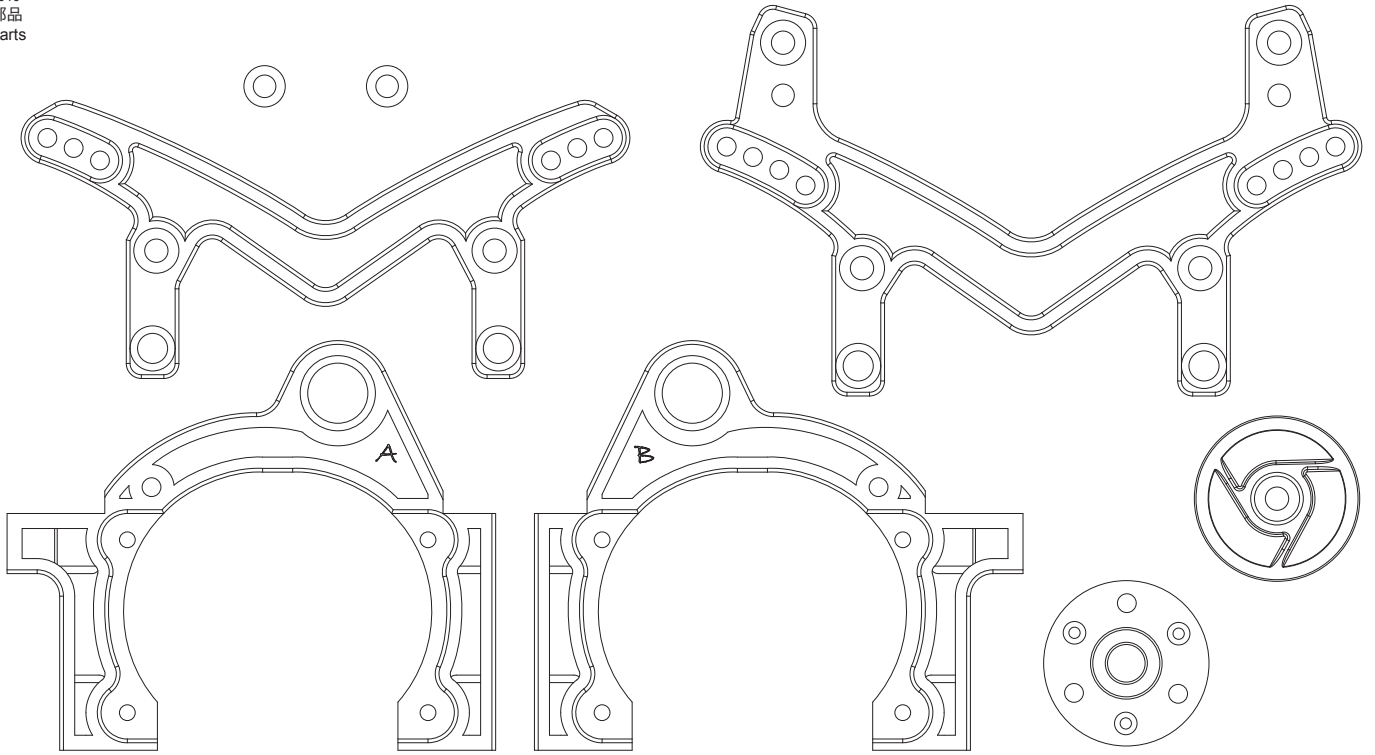

210283
MS 纖維前二樓板 2mm
MS Front upper deck (FRP) 2mm

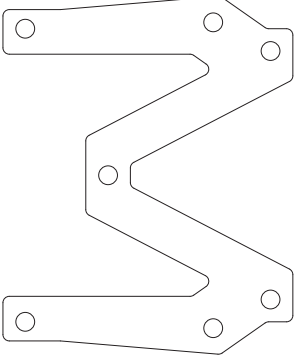

210284
MS 纖維後二樓板 2mm
MS Rear upper deck (FRP) 2mm

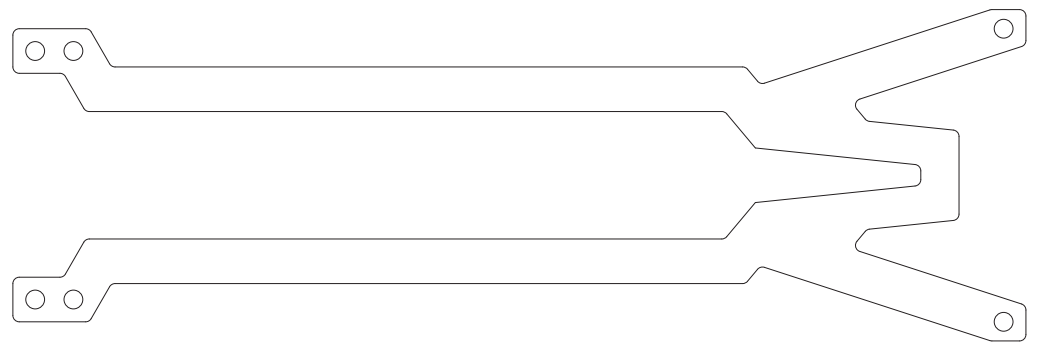

210012
N 部品
N parts

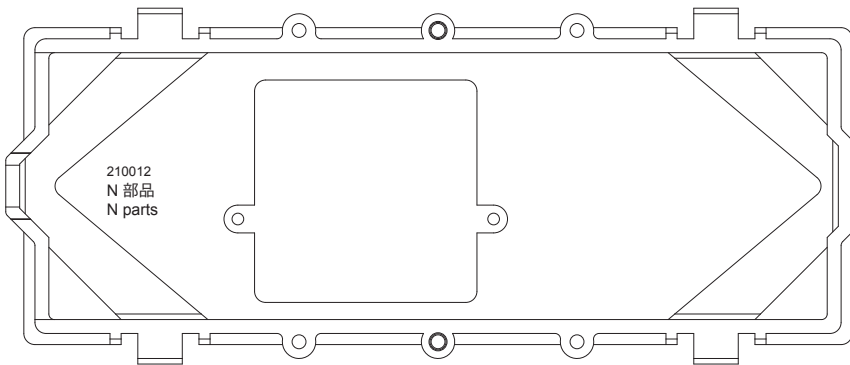

210014
O 部品
O parts

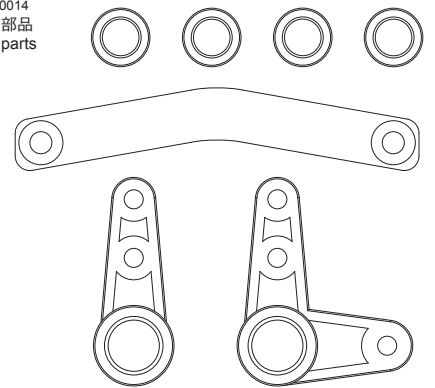

210145R
煞車卡鉗 (電鍍紅)
Brake calipers (red)

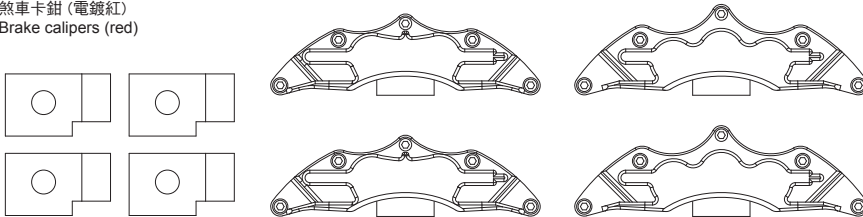

210032
伺服機舵片組 (23T/25T)
Servo horn set

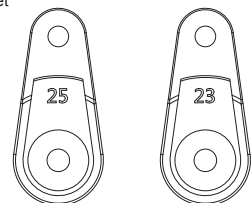

PARTS

齒比表 Gear Ratio

| 大齒盤 Spur Gear | 馬達齒 Pinion Gear | 齒輪比 Gear Ratio |
|-------------------------------|--------------------|-------------------|
| 88 (210013) (OP.148088) | 24 | 7.33 |
| | 25 | 7.04 |
| | 26 | 6.77 |
| | 27 | 6.52 |
| | 28 | 6.29 |
| 89 (OP.148089) | 23 | 7.74 |
| | 24 | 7.42 |
| | 25 | 7.12 |
| | 26 | 6.85 |
| | 27 | 6.59 |
| 90 (OP.148090) | 22 | 8.18 |
| | 23 | 7.83 |
| | 24 | 7.50 |
| | 25 | 7.20 |
| | 26 | 6.92 |
| 91 (OP.148091) | 21 | 8.67 |
| | 22 | 8.27 |
| | 23 | 7.91 |
| | 24 | 7.58 |
| | 25 | 7.28 |
| 92 (OP.148092) | 20 | 9.20 |
| | 21 | 8.76 |
| | 22 | 8.36 |
| | 23 | 8.00 |
| | 24 | 7.67 |

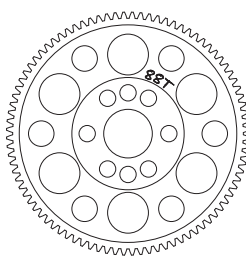

大齒盤 48P-88T ×1
Spur gear 48P-88T
210013

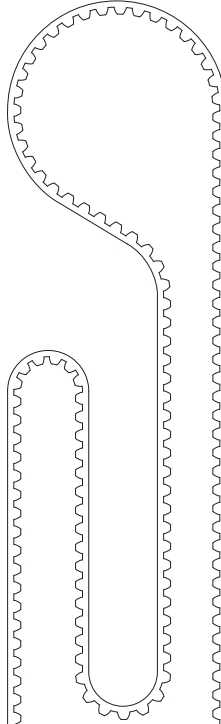

皮帶 (486) ×1
Drive belt (486)
414486

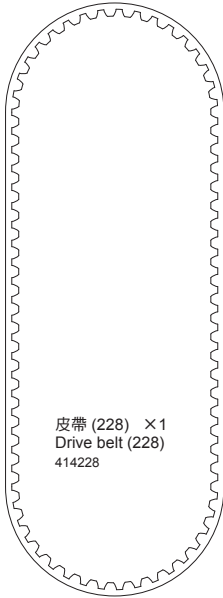

皮帶 (228) ×1
Drive belt (228)
414228

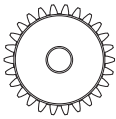

馬達齒 48P-26T ×1
Pinion gear 48P-26T
148026

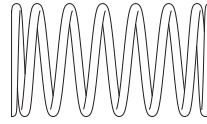

避震彈簧28mm (中) ×4
Coil spring 28mm (medium)
210144-2



4.8 外六角球頭螺帽 ×2
4.8 Ball connector nut
210161



4.8×5 球頭 ×8
Ball connector
310001



轉向支柱 ×2
Steering post
210183

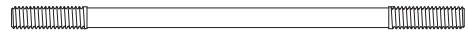

3×60 拉桿 ×1
Threaded shaft
310002

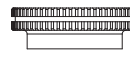

避震器調整環 ×4
Spring retainer
310004

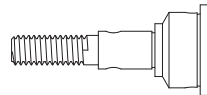

輪軸 ×4
Wheel axle
310006

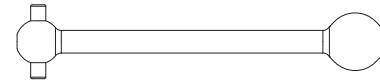

CVA傳動軸 ×4
CVA swing shaft
310007

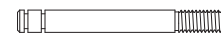

避震軸心 ×4
Piston rod
310008

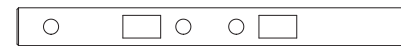

主齒軸 ×1
Direct center shaft
310009

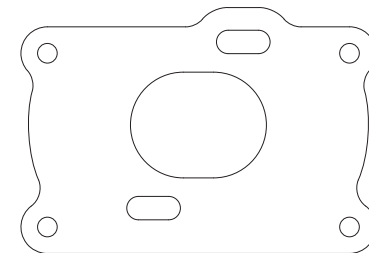

馬達座 ×1
Motor mount
310010

210016
R 部品
R parts

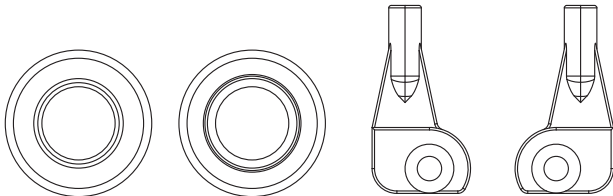

210111
反胎齒比組
CS pulley set

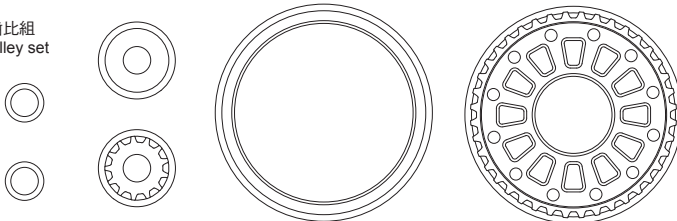

310042B
鋁合金單向組 (一般型)
Alum. ony way (general)

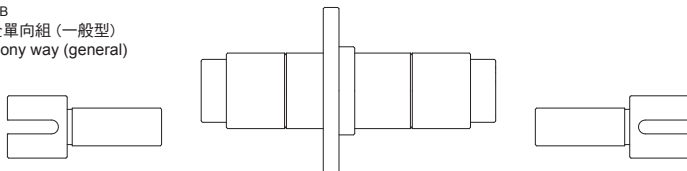

以實際搭載為主
Please make
the object as
the standard

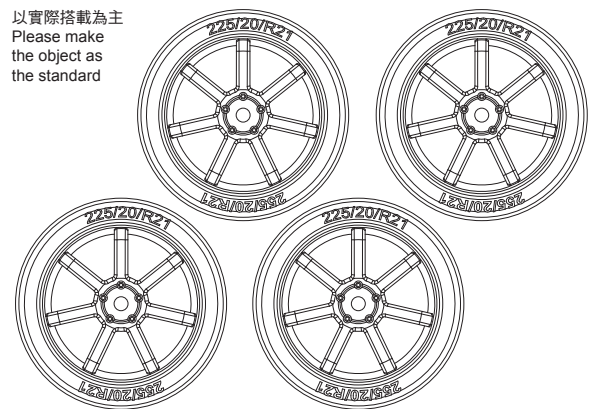

Front Wheel Hubs

0mm

Front Caster

Front lower arm "A"

4° 7° 10° 14°

Front lower arm "B"

0° 4° 7° 10°

Front Lower Arm

32.5mm

A B

Rear Lower Arm

35.5mm

A B

Rear Wheel Hubs

0mm

FRONT

Tire: _____ Wheel: _____ Offset: _____

REAR

Tire: _____ Wheel: _____ Offset: _____

Steering Arm

Plastic

Alum. Steering Arm

Front Damper Stay

1 2 3

Camber: 6°
Toe-in: +1°

Ride Height: 6 mm
 Droop: 6 mm

Front Rollcenter

0 mm 0 mm

Front Lower Arm

1 2

Front Damper

Shock Oil: 150 _____
 Length: 63 mm
 Spring: 28 mm
 Spring Color: Gold
 Piston: 1.2 mm
 Piston Hole: 3 _____

Front Upright

0mm 0mm

Standard Servo
 Standard Servo
 Low Profile Servo

Rear Upright

0mm 0mm

Rear Rollcenter

0mm 0mm

CS Ratio: 1.0 1.38 1.54 1.66 1.82 2.0

Gear Ratio: (Spur: 88 T / Pinion: 26 T) x 2.0 = 6.77

Motor & ESC: 540 22000rpm & B4222 Battery: _____

Chassis & Upper Deck

Plastic
 Carbon Fiber
 FRP

Front Anti-Roll Bar

1.0mm
 1.2mm
 1.4mm

Rear Anti-Roll Bar

1.0mm
 1.2mm
 1.4mm

Rear Damper Stay

1 2 3 4

Camber: 4°
Toe-in: 4°

Ride Height: 5 mm
 Droop: 7 mm

Rear Rollcenter

0mm 0mm

Rear Lower Arm

1 2 3 4

Rear Damper

Shock Oil: 150 _____
 Length: 63 mm
 Spring: 28 mm
 Spring Color: Gold
 Piston: 1.2 mm
 Piston Hole: 3 _____

Rear Diff

Spool
 Alum. Spool
 Separating Spool
 Alum. Ball Diff.

Ballast:

Front Diff.

Alum. One way

Spool

Ball Diff.

RECOMMENDED OPTION PARTS

for MS-01D series

210146

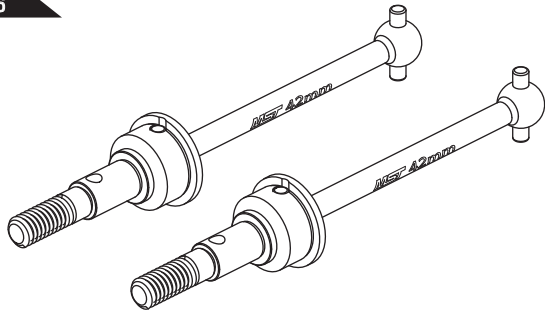

Steel CVD Shaft Set 42mm
鋼製CVD傳動軸組42mm

210143

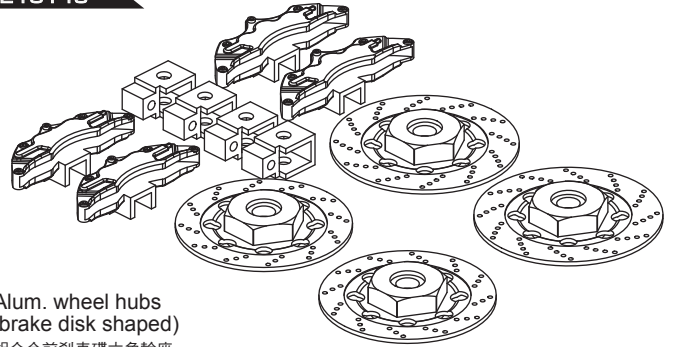

Alum. wheel hubs
(brake disk shaped)
鋁合金前剎車碟六角輪座

210123

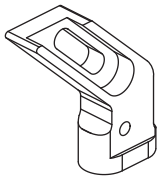

Alum. Belt Stabilizer Mount
鋁可調壓輪座

210211

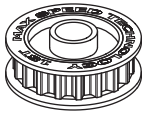

Alum. Pulley 18T
鋁皮帶輪18T

210207

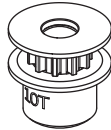

Alum. Pulley 10T
鋁皮帶輪10T

210208

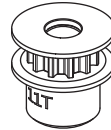

Alum. Pulley 11T
鋁皮帶輪11T

210209

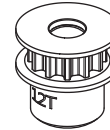

Alum. Pulley 12T
鋁皮帶輪12T

210210



Alum. Pulley 13T
鋁皮帶輪13T

210122

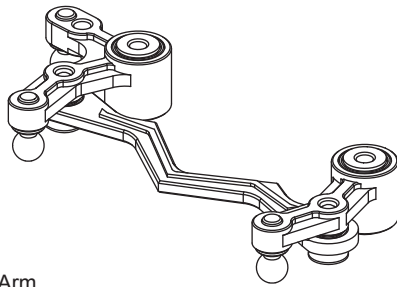

Alum. Steering Arm
鋁合金轉向雙搖臂組

210142

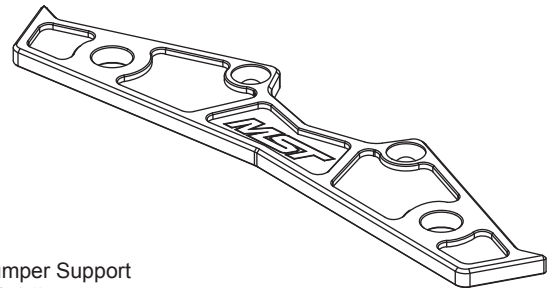

Alum. Bumper Support
鋁合金防撞板上蓋

210121

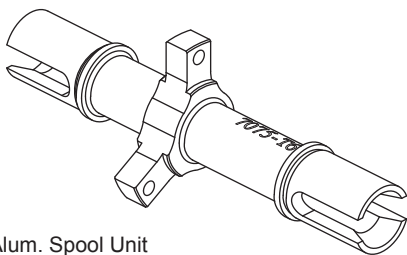

Alum. Spool Unit
鋁合金直輪組

210148

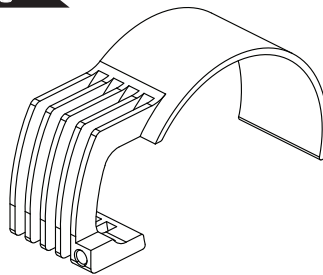

Alum. Motor Heatsink
鋁合金馬達散熱片

210204

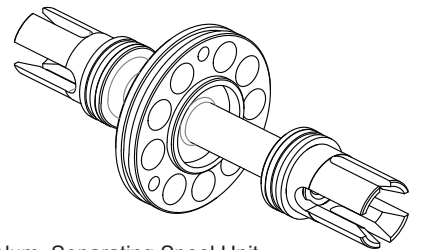

Alum. Separating Spool Unit
鋁合金分離式直輪組

210135

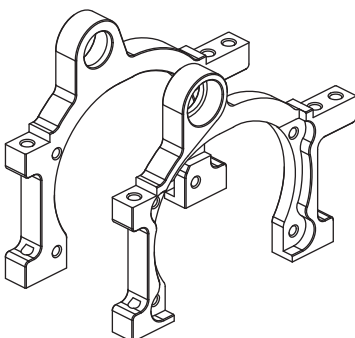

Alum. main shaft mount R/L
鋁合金主軸座組

210136

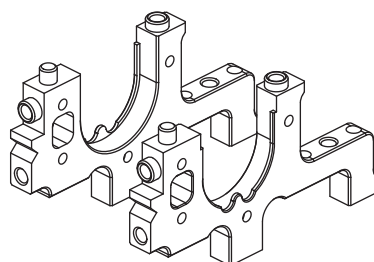

Alum. bulkhead R/L
鋁合金側板組

210134

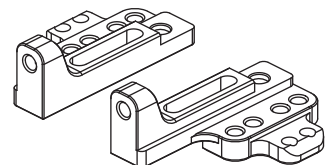

Alum. upper bulkhead R/L
鋁合金側板上蓋組

More details, please refer to MST website.
更多詳細內容，請上官網。

[www.rc-mst.com]

PARTS CODE

| | | | | | | | |
|--------|------------------------------|--------|-----------------------------|----------|--|--------|--------------------------------------|
| 110001 | Round head screw M3×6 (10) | 110025 | Taping screw 2.6×10(6) | 210003 | D PARTS | 210284 | MS Rear upper deck (carbon look) 2.0 |
| 110002 | Round head screw M3×8 (10) | 110026 | Round head screw M3×10 (10) | 210004 | E PARTS | 310001 | Ball connector 4.8×4.5 (5) |
| 110003 | Round head screw M2.5×6 (6) | 110029 | Round head screw M3×12 (6) | 210005 | F PARTS | 310002 | Threaded shaft 3×60 |
| 110004 | Round head screw M2×4 (6) | 110032 | Set screw M3×10 (6) | 210006 | G PARTS | 310004 | Spring retainer (2) |
| 110005 | Flat head screw M3×8 (10) | 110035 | Set screw M3×3 (6) | 210007 | H PARTS | 310006 | Wheel axle (2) |
| 110006 | Set screw M3×5 (6) | 110061 | Round head screw M3×14 (6) | 210008 | I PARTS | 310007 | CVA swing shaft (2) |
| 110008 | Set screw M3×25 (6) | 120001 | Ball bearing 10×15 (4) | 210009 | J PARTS | 310008 | Piston rod (4) |
| 110009 | Set screw M3×20 (6) | 120002 | Ball bearing 5×10 (4) | 210010 | K PARTS | 310009 | Direct center shaft |
| 110010 | Round head screw M2.5×14 (6) | 130001 | Damper O-ring P3 (red)(10) | 210012 | N PARTS | 310010 | Motor mount |
| 110011 | Cap screw M3×6 (6) | 130002 | O-ring 11.5×1.5 (4) | 210013 | Spur gear 88T-48P | 310042 | Alum. one way (general) |
| 110012 | Flat head screw M3×11 (10) | 130003 | Battery O-ring (S)(2) | 210014 | O PARTS | 310043 | One way outrdrive (general)(2) |
| 110013 | E-clip E2.0 (10) | 130004 | Oil seal (4) | 210016 | R PARTS | 414228 | Drive belt-228 |
| 110014 | Flat head screw M3×13 (10) | 130005 | Bumper (A) | 210043 | Wheel hubs w/disc shape | 414486 | Drive belt-486 |
| 110015 | Flange nut M4 (4) | 130006 | Double sided tape (5) | 210057 | Damper cap set | 600002 | XTR-02 2.4G Transceiver set |
| 110016 | R-clip R6 (10) | 130007 | Antenna pipe(2) | 210111 | CS pulley set (1.54/1.66/1.82) | 601001 | 2200RPM brushed motor |
| 110017 | Shaft 2×9.8 (10) | 130011 | Tools | 210144-2 | Coil spring set 28 (medium) (gold) (2) | 601002 | RTR brushed ESC |
| 110018 | Shaft 2×13.8 (5) | 130032 | Damper cap O-ring (10) | 210145R | Brake calipers-red (4) | 601003 | RTR servo |
| 110019 | Shaft 2×11.8 (5) | 148026 | MST 48P Pinion gear 26T | 210161 | 4.8 ball connector nut (4) | | |
| 110023 | Set screw M3×16 (6) | 210001 | Chassis | 210183 | Alum. steering post (2) | | |
| 110024 | Flat head screw M3×6 (10) | 210002 | C PARTS | 210283 | MS Front upper deck (carbon look) 2.0 | | |

OPTION PARTS CODE

| | | | | | | | |
|-----------|----------------------------------|--------|--------------------------------------|----------|---|--------|--|
| 414225 | Drive belt-225 | 210117 | Alum. spur gear holder (1) | 210136 | Alum. bulkhead R/L (blue) | 210163 | Alum. hex wheel hubs (4) |
| 414225J | Drive belt-225 (Japan) | 210118 | Alum. upright (blue) (2) | 210137 | 4mm Turnbuckle wrench | 210165 | Alum. turnbuckle 3×20 (blue) (2) |
| 414486J | Drive belt-486 (Japan) | 210119 | Front ball diff joint | 210140 | Carbon battery holder set (black) | 210166 | Steel turnbuckle 3×20 (blue) (2) |
| 414222J | Drive belt-222 (Japan) | 210120 | Alum. high torque servo saver (F/KO) | 210141 | Carbon ESC plate | 210167 | Alum. turnbuckle 3×25 (blue) (2) |
| 910004-L | MST T-shirt L | 210121 | Alum. spool unit | 210142 | Alum. bumper support | 210168 | Steel turnbuckle 3×25 (blue) (2) |
| 910004-XL | MST T-shirt XL | 210122 | Alum. steering arm | 210143 | Alum. Wheel Hubs (Brake Disc Shaped)(4) | 210178 | Front motor mount conversion kit |
| 910004-2L | MST T-shirt 2L | 210123 | Alum. belt stabilizer mount | 210144 | Coil spring set 28 (8) | 210190 | Reinforced suspension arm set (2) |
| 910004-3L | MST T-shirt 3L | 210124 | Alum. belt pulley | 210145 | Brake calipers (4) | 210192 | MS chassis set (8 pieces) |
| 210101 | Alum. Servo mount (2) | 210125 | Carbon front upper deck | 210145B | Brake calipers-blue (4) | 210198 | Steel turnbuckle 3×28 (blue) (2) |
| 210102 | Alum. one way unit | 210126 | Carbon rear upper deck | 210145GD | Brake calipers-Gold (4) | 210204 | Alum. separating spool unit |
| 210104 | Front ball diff unit | 210127 | Carbon front damper stay | 210146 | Steel CVD universal shaft set (2) | 210205 | DK Coil spring set 30 |
| 210105 | Alum. turnbuckle shaft 3×60 (1) | 210128 | Carbon rear damper stay | 210147 | Servo Saver Spring (hard) (black) | 210206 | Alum. Antenna Pipe Mount (Generalized) |
| 210108 | Alum. turnbuckle shaft 3×28 (2) | 210129 | Carbon bulkhead brace | 210148 | Alum. motor heatsink | 210207 | Alum. Pulley 10T |
| 210110 | Stabilizer set (F/R) | 210130 | Carbon lower deck | 210151 | Alum. damper cylinder (4) | 210208 | Alum. Pulley 11T |
| 210112 | Main shaft mount supporting bar | 210131 | High torque servo saver (F/KO) | 210155 | Servo Saver Spring(medium)(blue) | 210209 | Alum. Pulley 12T |
| 210113 | Rear ball diff unit | 210132 | 4.8 ball connector (5) | 210157 | Alum. CVD universal shaft set (2) | 210210 | Alum. Pulley 13T |
| 210114 | Alum. motor heat sink mount | 210133 | 5.8 ball connector (5) | 210159 | 5.8x4 ball connector (4) | 210211 | Alum. Pulley 18T |
| 210115 | Alum. damper set (4) | 210134 | Alum. upper bulkhead R/L (blue) | 210160 | 5.8x6 ball connector (4) | 210235 | Piston spacer set |
| 210116 | Alum. spur gear holder cover (1) | 210135 | Alum. main shaft mount R/L | 210162 | Alum. small belt pulley mount | 210273 | Damper spring set 29mm |

部品編號

| | | | | | | | |
|--------|----------------------|--------|----------------------|----------|-------------------------|--------|-------------------|
| 110001 | 六角半圓頭螺絲 M3×6 (10) | 110025 | 自攻六角半圓頭螺絲 2.6×10 (6) | 210003 | D 部品 | 210284 | MS 纖維後二樓板 2.0 |
| 110002 | 六角半圓頭螺絲 M3×8 (10) | 110026 | 六角半圓頭螺絲 M3×10 (10) | 210004 | E 部品 | 310001 | 內六角公球頭4.8×4.5 (5) |
| 110003 | 六角半圓頭螺絲 M2.5×6 (6) | 110029 | 六角半圓頭螺絲 M3×12 (6) | 210005 | F 部品 | 310002 | 拉桿3×60 |
| 110004 | 六角半圓頭螺絲 M2×4 (6) | 110032 | 六角止付螺絲 M3×10 (6) | 210006 | G 部品 | 310004 | 避震器調整環 (2) |
| 110005 | 六角沉頭螺絲 M3×8 (10) | 110035 | 六角止付螺絲 M3×3 (6) | 210007 | H 部品 | 310006 | 萬向接杯 (2) |
| 110006 | 六角止付螺絲 M3×5 (6) | 110061 | 六角半圓頭螺絲 M3×14 (6) | 210008 | I 部品 | 310007 | CVA狗骨 (2) |
| 110008 | 六角止付螺絲 M3×25 (6) | 120001 | 培林 10×15 (4) | 210009 | J 部品 | 310008 | 避震軸心 (4) |
| 110009 | 六角止付螺絲 M3×20 (6) | 120002 | 培林 5×10 (4) | 210010 | K 部品 | 310009 | 主齒軸 |
| 110010 | 六角半圓頭螺絲 M2.5×14 (6) | 130001 | 阻尼器O環 P3 (紅) (10) | 210012 | N 部品 | 310010 | 馬達座 |
| 110011 | 六角有頭螺絲 M3×6 (半牙) (6) | 130002 | O環 11.5×1.5 (4) | 210013 | 大齒盤 88T-48 | 310042 | 鋁合金單向組 (一般型) |
| 110012 | 十字扁頭螺絲 M3×11 (10) | 130003 | 電池O環 (S) (2) | 210014 | O 部品 | 310043 | 單向接杯 (一般型) (2) |
| 110013 | E扣 2.0 (10) | 130004 | 避震氣室 (4) | 210016 | R 部品 | 414228 | 皮帶-228 |
| 110014 | 公制十字扁頭螺絲 M3×13 (10) | 130005 | 防撞泡棉 (A) | 210043 | 碟型六角輪座組 | 414486 | 皮帶-486 |
| 110015 | 凸緣螺帽 M4 (4) | 130006 | 泡棉雙面膠 (5) | 210057 | 避震器上下蓋組 | 600002 | XTR-02 2.4G 遙控器組 |
| 110016 | R銷 6 (10) | 130007 | 天線管 (2) | 210111 | 反胎齒比總成 (1.54/1.66/1.82) | 601001 | 2200RPM 有刷 馬達 |
| 110017 | 插銷 2×9.8 (10) | 130011 | 工具包 | 210144-2 | 避震彈簧28 (中) (金) (2) | 601002 | 電子變速器 ESC-RTR |
| 110018 | 插銷 2×13.8 (5) | 130032 | 避震上蓋O環 (10) | 210145R | 煞車卡鉗 (電鍍紅) (4) | 601003 | SG5010 伺服機 |
| 110019 | 插銷 2×11.8 (5) | 148026 | MST 48P 馬達齒 26T | 210161 | 4.8 外六角球頭螺帽 (4) | | |
| 110023 | 六角止付螺絲 M3×16 (6) | 210001 | 底盤 | 210183 | 轉向支柱(2) | | |
| 110024 | 六角沉頭螺絲 M3×6 (10) | 210002 | C 部品 | 210283 | MS 纖維前二樓板 2.0 | | |

改裝品編號

| | | | | | | | |
|-----------|------------------------|--------|-------------------|----------|------------------|--------|--------------------|
| 414225 | 皮帶-225 | 210117 | 鋁合金主齒固定座 (1) | 210136 | 鋁合金板 R/L (藍) | 210163 | 鋁合金六角輪座 (4) |
| 414225J | 日製皮帶-225 | 210118 | 鋁合金轉向輪座 (藍) (2) | 210137 | 4mm 拉桿扳手 | 210165 | 鋁可調拉桿 3×20 (藍) (2) |
| 414486J | 日製皮帶-486 | 210119 | 前金屬滾珠差速接杯 | 210140 | 碳纖維電池座組 (黑) | 210166 | 鋼可調拉桿 3×20 (藍) (2) |
| 414222J | 日製皮帶-222 | 210120 | 鋁合金強力伺服緩衝器 (F/KO) | 210141 | 碳纖維電變托盤 | 210167 | 鋁可調拉桿 3×25 (藍) (2) |
| 910004-L | MST T-shirt 衣服 L | 210121 | 金屬直軸組 | 210142 | 鋁合金防撞板上蓋 | 210168 | 鋼可調拉桿 3×25 (藍) (2) |
| 910004-XL | MST T-shirt 衣服 XL | 210122 | 鋁合金轉向雙搖臂組 | 210143 | 鋁合金剎車碟六角輪座 (1車份) | 210178 | FS 前置馬達套件 |
| 910004-2L | MST T-shirt 衣服 2L | 210123 | 鋁合金可調後皮帶壓輪座 | 210144 | 避震彈簧組28(4種硬度) | 210190 | 強化擺臂組 (2) |
| 910004-3L | MST T-shirt 衣服 3L | 210124 | 鋁合金後皮帶壓輪 | 210145 | 煞車卡鉗 (無烤漆) (4) | 210192 | MS 全車銀 板件組 (8件組) |
| 210101 | 鋁合金伺服機座 (2) | 210125 | 碳纖維二樓板 F | 210145B | 煞車卡鉗 (電鍍藍) (4) | 210198 | 鋼可調拉桿 3x28 (2) |
| 210102 | 鋁合金前單向組 (含前單接杯/皮帶齒壓板1) | 210126 | 碳纖維二樓板 R | 210145GD | 煞車卡鉗 (電鍍金) (4) | 210204 | 鋁合金分離式直軸組 |
| 210104 | 前滾珠差速總成 | 210127 | 碳纖維避震架 F | 210146 | 大角度CVD傳動軸組 (2) | 210205 | DK避震彈簧組 30 |
| 210105 | 鋁可調拉桿 3×60 | 210128 | 碳纖維避震架 R | 210147 | 緩衝器簧圈(硬) (黑) | 210206 | 鋁合金天線管座(通用型) |
| 210108 | 鋁可調拉桿 3×28 (2) | 210129 | 碳纖維側板補強片 | 210148 | 鋁合金馬達散熱片 (可固定風扇) | 210207 | 鋁合金皮帶輪10T |
| 210110 | 防傾桿組 (半車份/前後通用) | 210130 | 碳纖維底盤 | 210151 | 鋁合金避震筒身 (4) | 210208 | 鋁合金皮帶輪11T |
| 210112 | 主軸座支撐桿 | 210131 | 強化伺服緩衝器 (F/KO) | 210155 | 緩衝器簧圈/中 (藍) | 210209 | 鋁合金皮帶輪12T |
| 210113 | 後金屬滾珠差速器組 | 210132 | 4.8金屬球頭(5) | 210157 | 鋁合金CVD傳動軸組 (2) | 210210 | 鋁合金皮帶輪13T |
| 210114 | 鋁合金馬達散熱固定座 | 210133 | 5.8金屬球頭(5) | 210159 | 5.8x4 球頭螺絲 (4) | 210211 | 鋁合金皮帶輪18T |
| 210115 | 鋁合金避震器組 (4) | 210134 | 鋁合金上蓋組 R/L (藍) | 210160 | 5.8x6 球頭螺絲 (4) | 210235 | 避震器活塞墊片組 |
| 210116 | 鋁合金主齒固定板 (1) | 210135 | 鋁合金主軸座 R/L | 210162 | 鋁合金小皮帶壓輪座組 | 210273 | 彈簧組 29mm |